

EVENT SPACE CAPACITIES

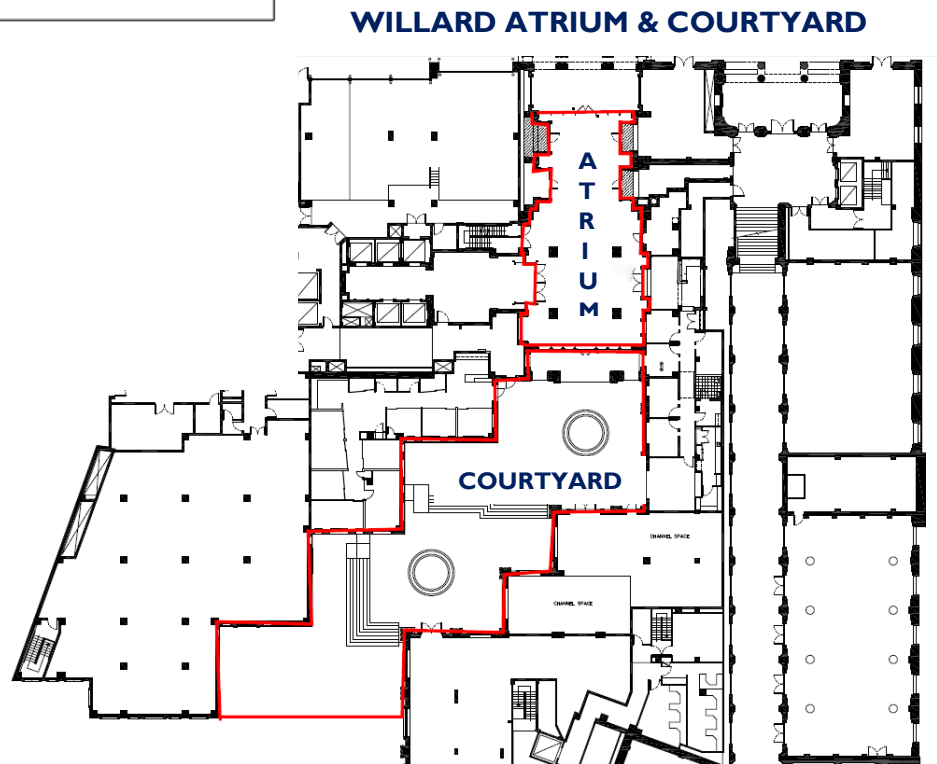
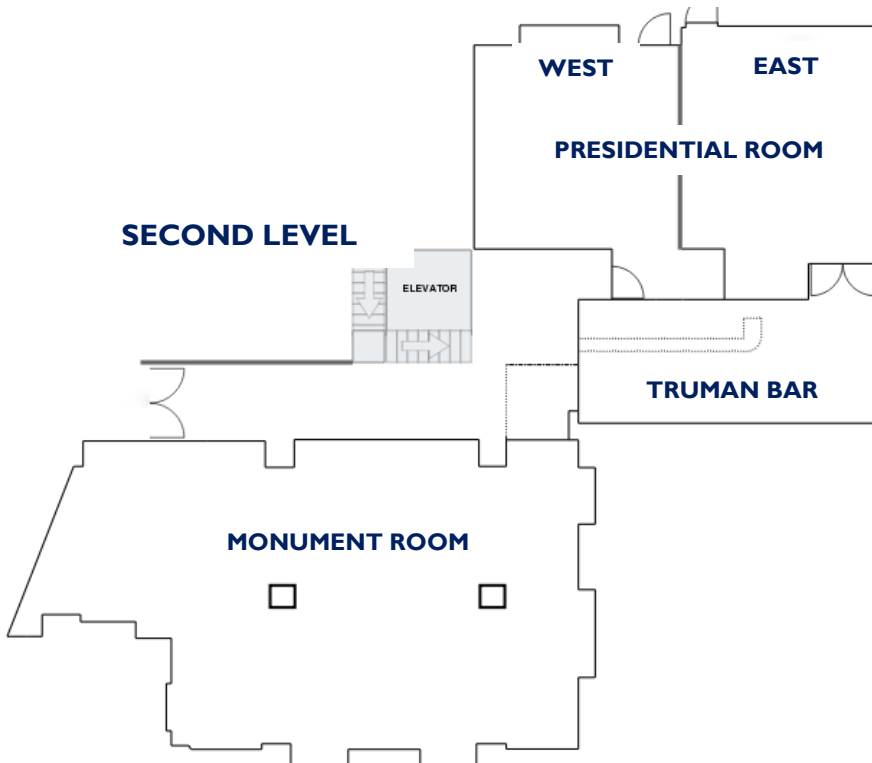

	DIMENSIONS	TOTAL SQ.FT.	CEILING HEIGHT	ROUNDS	THEATER	CONFERENCE	STANDING	CLASS	USHAPE	HOLLOW SQUARE
MONUMENT ROOM	49' X 29'	1334		120	80	36	160	30	27	34
PRESIDENTIAL ROOM	38' X 20'	805		56	70	32	80	30	28	30
PRESIDENTIAL EAST	18' X 20'	385		32	35	16	36	18	15	--
PRESIDENTIAL WEST	19' X 20'	420		30	35	16	30	18	15	--
TRUMAN BAR	28' X 12'	439		--	--	--	60	--	--	--
WILLARD ATRIUM	70' X 30'	2472		100	--	40	160	--	--	--
COURTYARD	34' X 39'	7253		100	--	40	160	--	--	--